

# Existing Site Plan

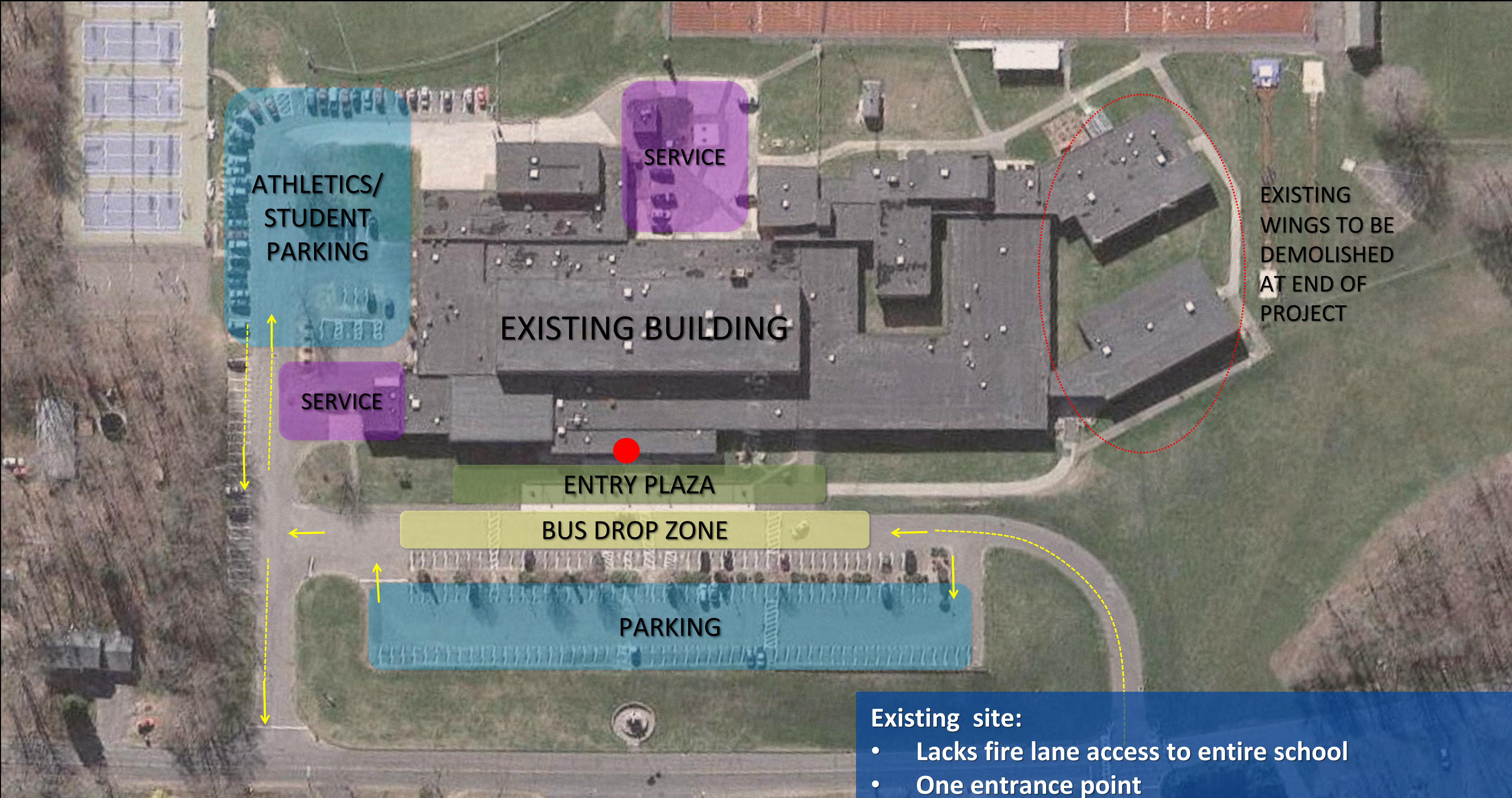

- Existing site:
- Lacks fire lane access to entire school
  - One entrance point
  - All traffic must go through main parking or bus drop-off
  - Parking behind school unclear, dead-end
  - Parking remote from athletic fields

# Proposed Site Plan

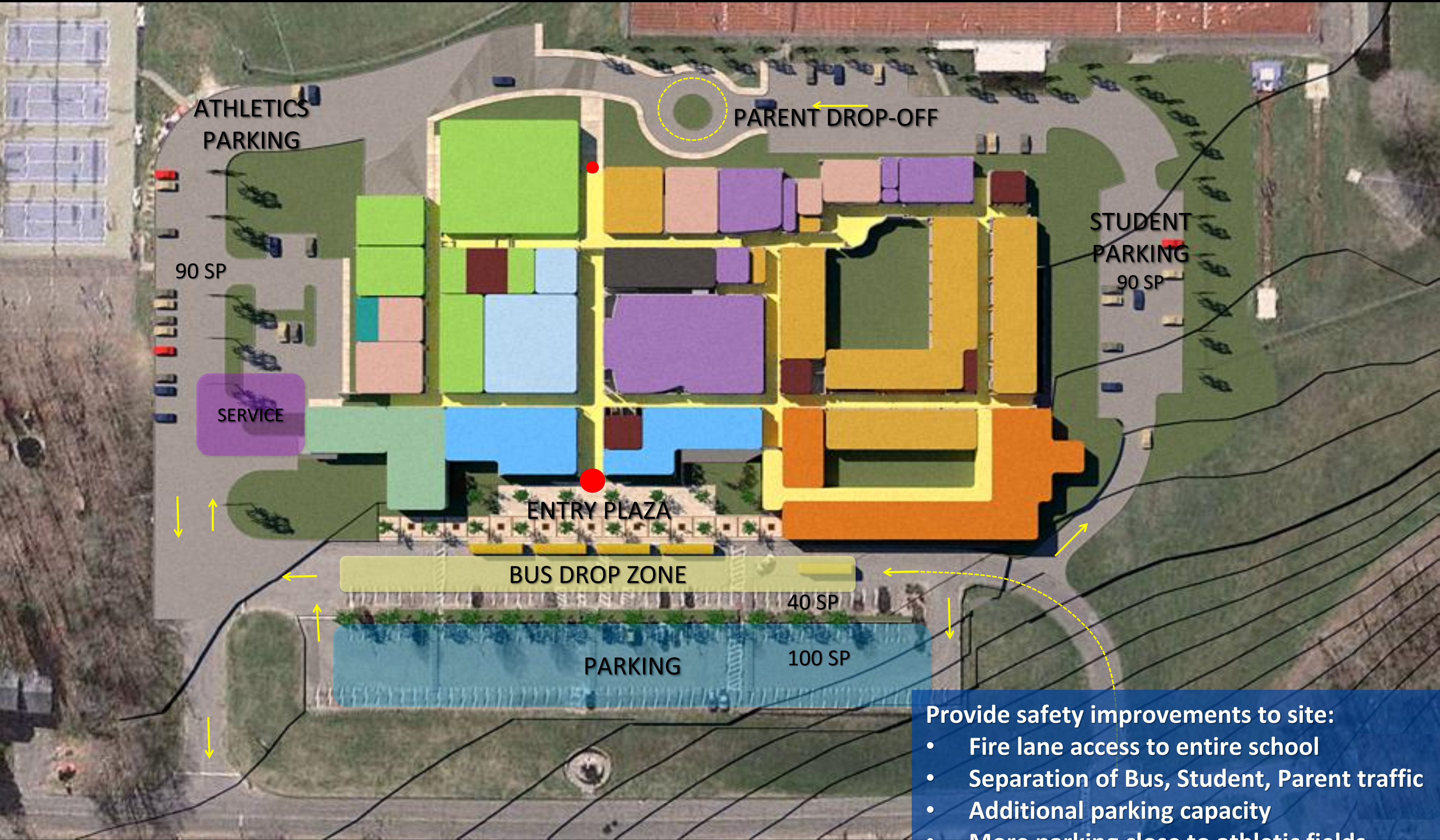

- Provide safety improvements to site:
- Fire lane access to entire school
  - Separation of Bus, Student, Parent traffic
  - Additional parking capacity
  - More parking close to athletic fields





# Existing Building Plan

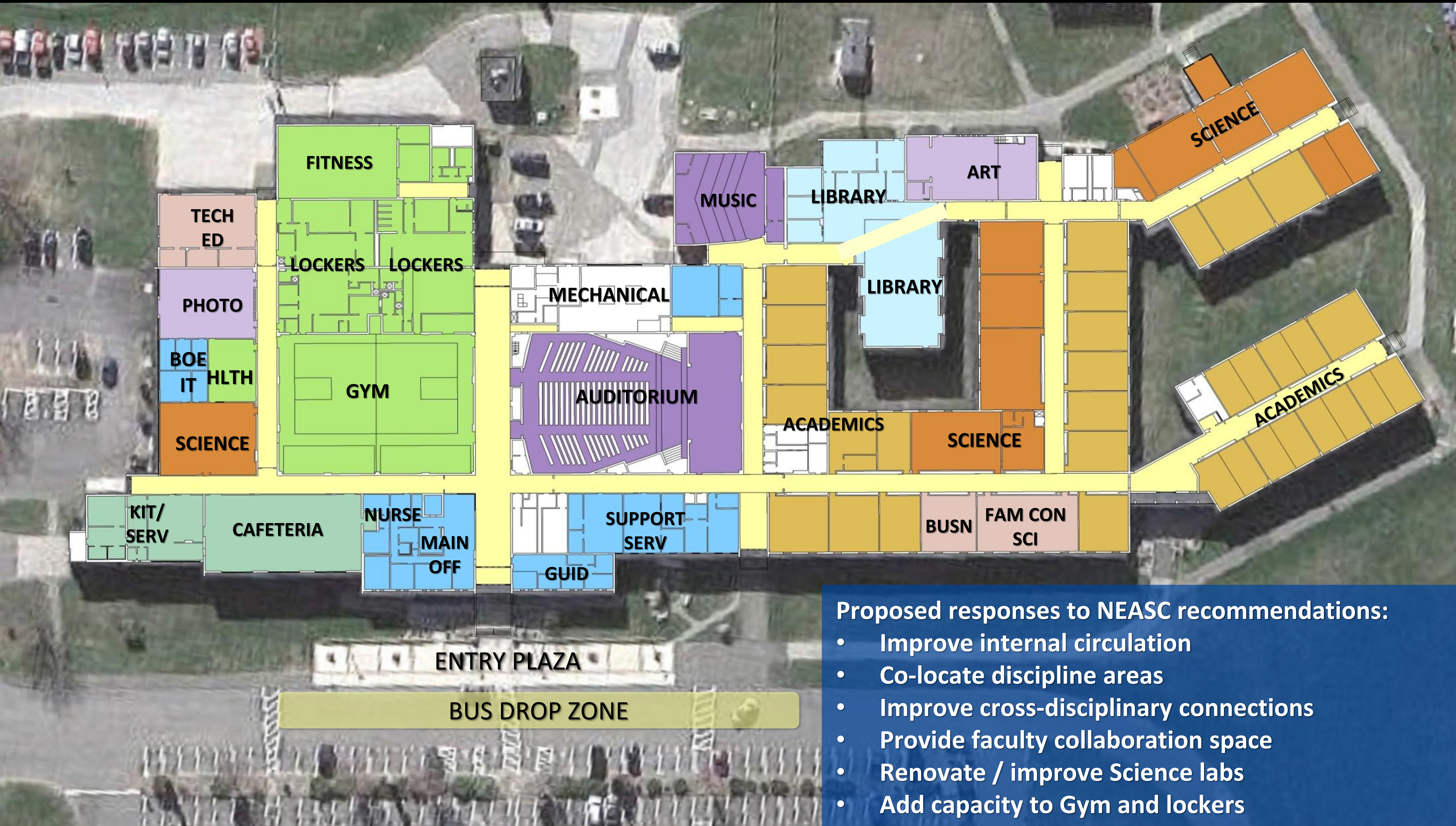

- Proposed responses to NEASC recommendations:
- Improve internal circulation
  - Co-locate discipline areas
  - Improve cross-disciplinary connections
  - Provide faculty collaboration space
  - Renovate / improve Science labs
  - Add capacity to Gym and lockers
  - Add to Student Services, Health & Guidance areas
  - Make comprehensive technology upgrades

# Proposed Concept Plan

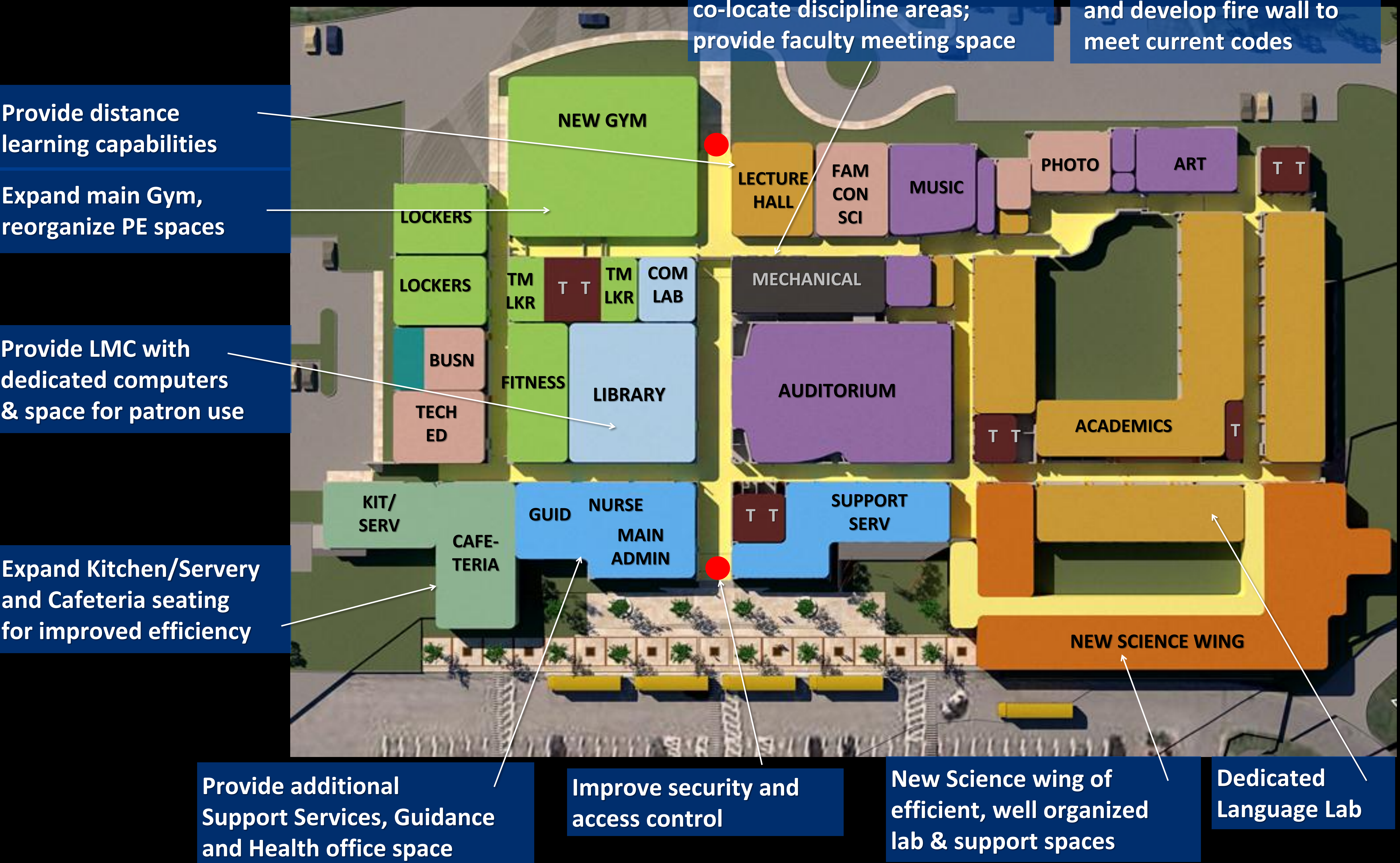



## An architectural rendering of a school campus. In the foreground, a paved walkway with a pattern of light and dark sections leads towards a brick building. Several young people are walking along the path. A row of young trees is planted along the walkway. To the left, a large tree with green leaves is partially visible. The brick building has large windows and a flat roof. In the background, a yellow school bus is parked on a road. The sky is blue with some light clouds. The word "SLAM" is visible in the bottom right corner.

## Infrastructure Improvements

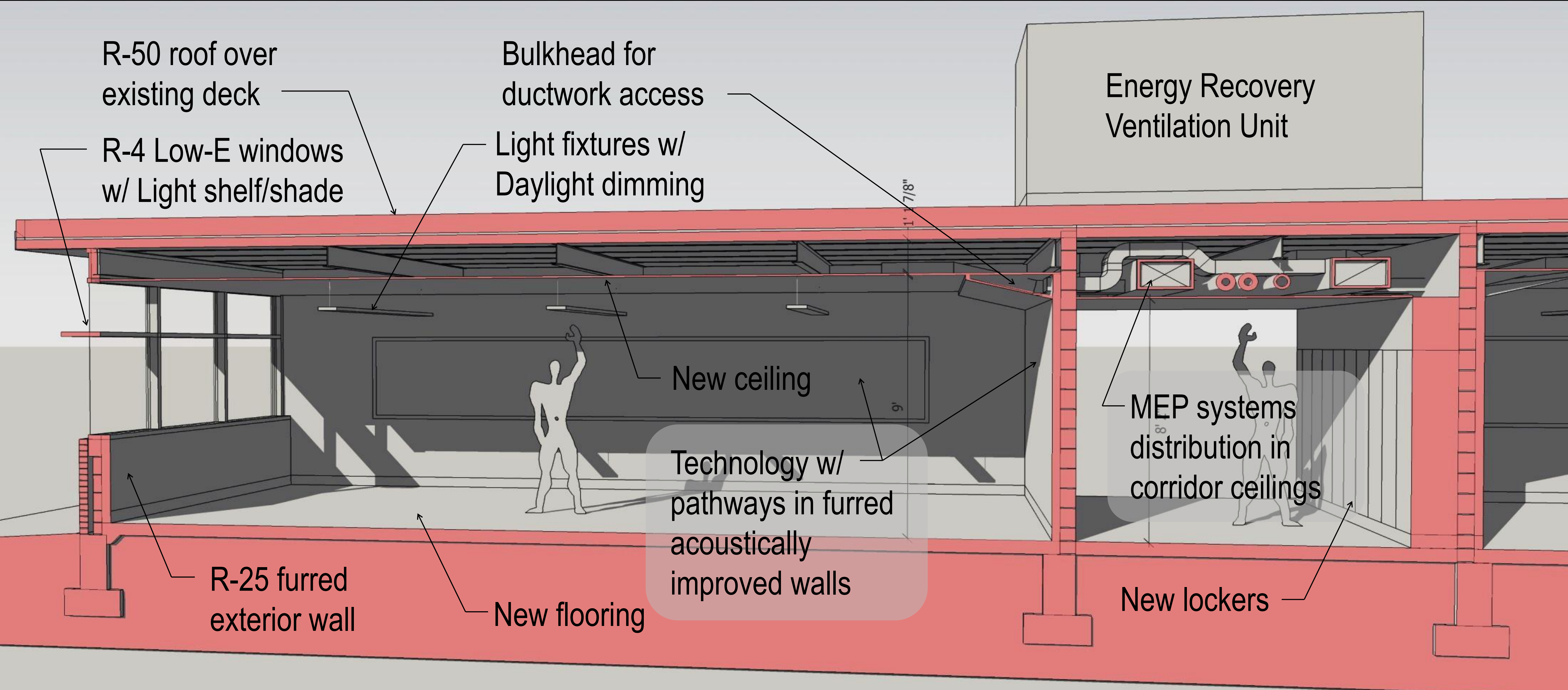

- **Insulation in the exterior walls and roof**
- **Energy efficient / operable windows**
- **Complete sprinkler system**
- **Energy efficient mechanical ventilation system**
- **Code compliant doors and hardware**
- **Hallway lockers sized for backpacks**
- **Integrated technology backbone**



# Science Labs

Provide new Science wing of efficiently sized and organized lab and support spaces.



*Existing Science Lab*



*Possible Design*

# Classroom Space

- Provide mix of appropriately sized classrooms of correct quantity
- Provide comprehensive integrated technology backbone and additional equipment



*Existing Classroom*



*Design must integrate multiple devices*



EAST HAMPTON PUBLIC SCHOOLS

The **S / L / A / M** Collaborative



# Gym

Provide new bleachers meeting HC requirements  
in expanded Gym with additional practice space  
Provide new PE lockers



*Existing Gymnasium*



*Possible Design*

# Cafeteria



*Existing Cafeteria*

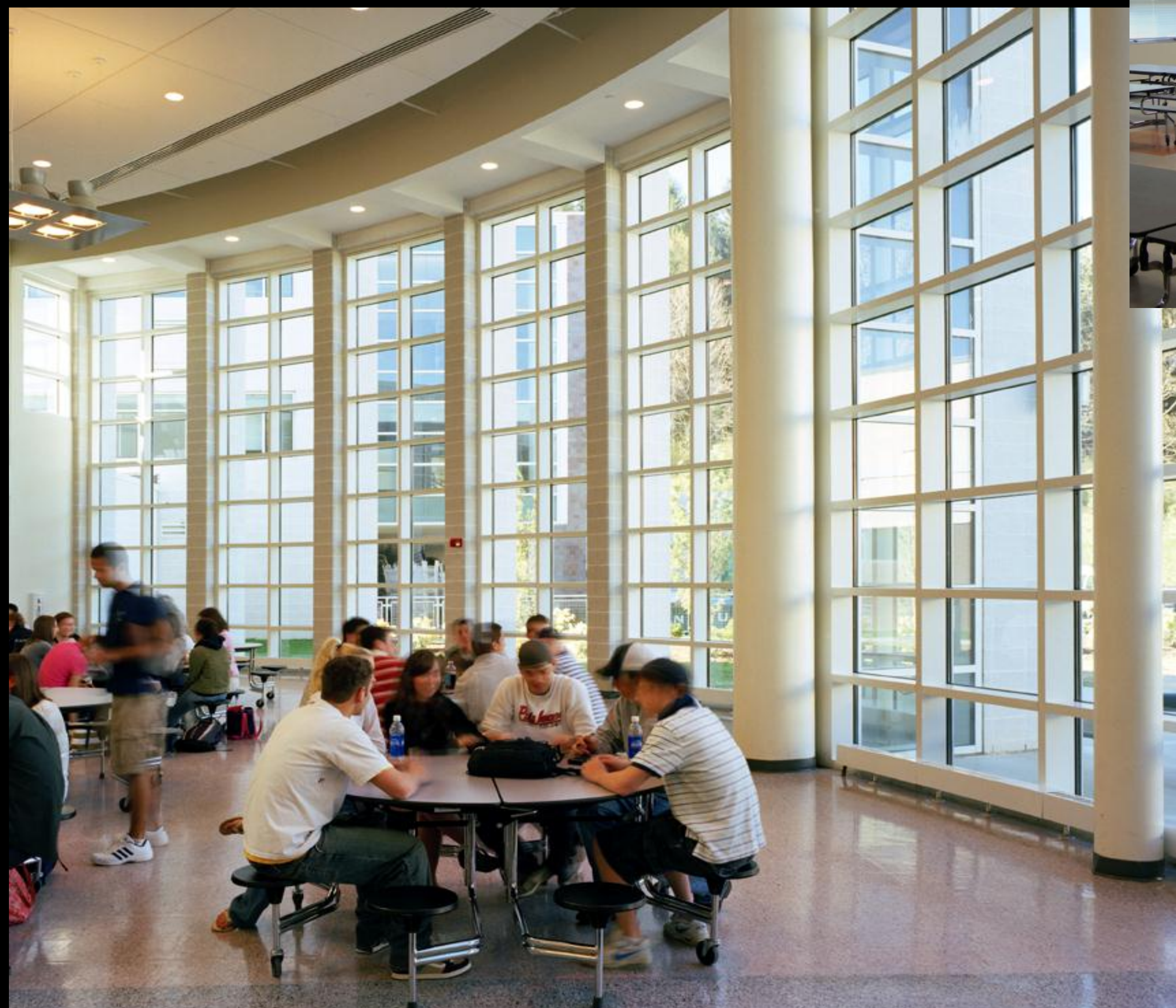

Reorganize Kitchen/Servery  
and Cafeteria seating space  
for improved efficiency

- New seating area frees space for adjacent Admin functions

*Possible Design*

